

847c

Delhi Development Authority  
Planning Zones P-1 & P-11 (Narela Sub-City)  
11th Floor, Vyas Minar, IP, Estate, New Delhi-110002

**KEY PLAN**

Layout Plan of IFC, Narela

**TOTAL AREA OF PLOT 1.05 Ha. (10,561 sqm.)**

i) Utility (Area Under Plot for installation of online booster) 200 sqm.

ii) Recreational (Park) 10,361 sqm.

5(i)  
370 : 63 : 2019

**Legend**  
 [Hatched Box] Plot for the construction of online booster  
 [Dotted Box] Park

**NOTE:**  
 1. Prepared on the basis of TSS received from Engineering Department, ND-9, DDA vide letter dated 05/07/2019.  
 2. All dimensions are in meter.

**TITLE:**  
 Part Layout Plan for providing 200 sqm. plot for installation of online booster pump at IFC, Narela.

DESIGNED BY	ASST. DIR. (P.L.G.)
CHECKED BY	ASST. DIR. (P.L.G.)
APPROVED BY	COMDR. (P.L.G.)
DATE	

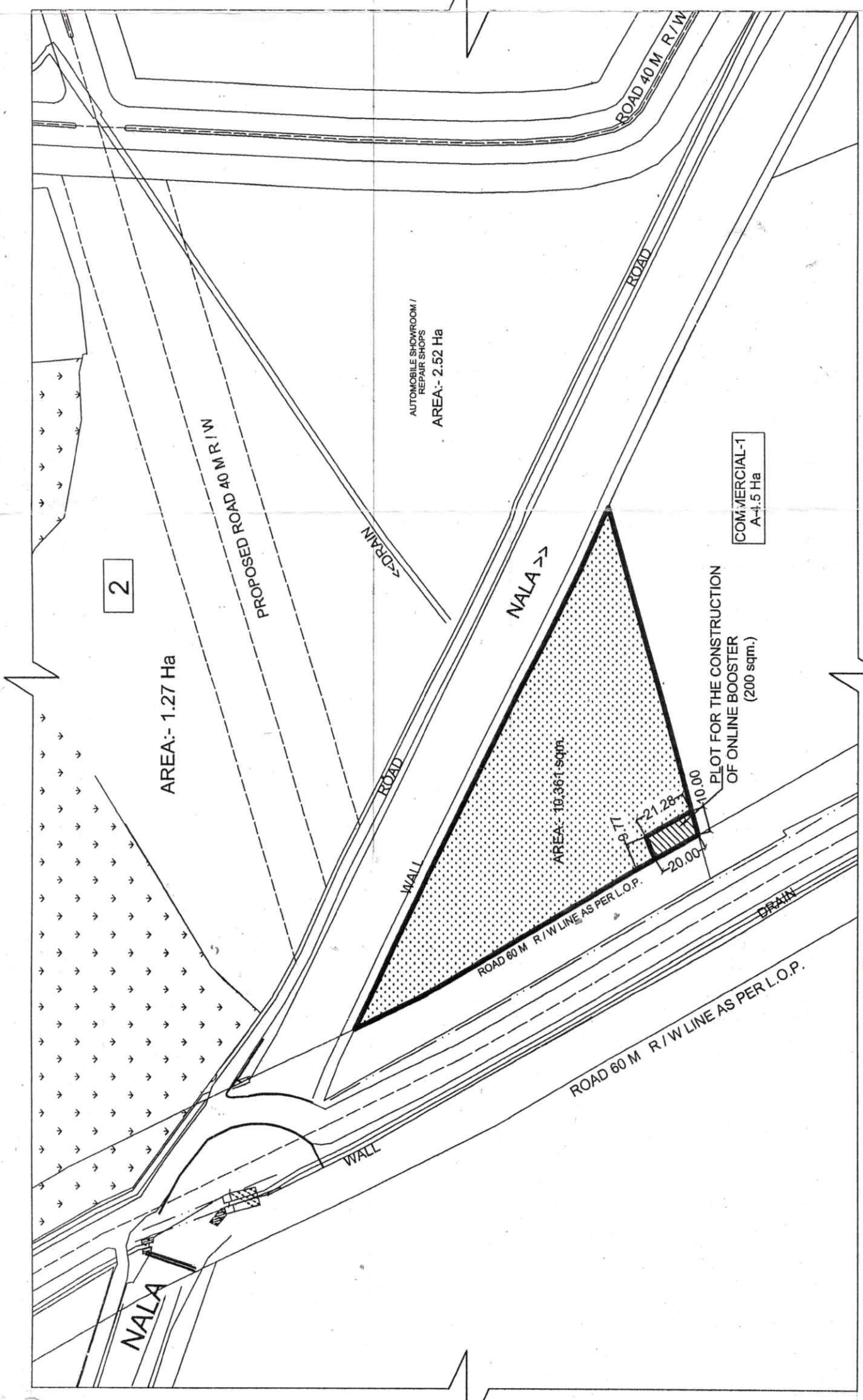

THE PROPOSAL WAS PRESENTED BY DIR (PLG) NP AFTER DETAILED DELIBERATION, THE PROPOSAL AS REFLECTED IN THE AGENDA WAS APPROVED.

DELHI DEVELOPMENT AUTHORITY  
HUPW/CO-ORDINATION UNIT  
**VERIFIED**  
This proposal was considered in the Meeting held on 17.06.2019  
Vide item No. 63:2019  
By: Director (Arch.) Co-ordn.

DELHI DEVELOPMENT AUTHORITY  
**CERTIFIED**  
Approved in S.O. No. 370/2019  
Committee Meeting Dt. 17.06.2019  
Vide Item No. 63:2019  
Sign. [Signature] 15/6/19  
Name: [Name]  
एच.ओ. के.ओ. भारतीय  
निदेशक (योजना) नरेला परियोजना  
दिल्ली विकास प्राधिकरण  
11वीं मंजिल, विकास मीनार  
नई दिल्ली-110002